

Courses & distances up
Clarion River from W.O.

- N^o 1 N. 87 E. 36
- " 2 N. 70 E. 48
- " 3 N. 67 E. 60
- " 4 N. 76 E. 60
- " 5 N. 68 E. 30
- " 6 N. 75 1/2 E. 47.5 to post

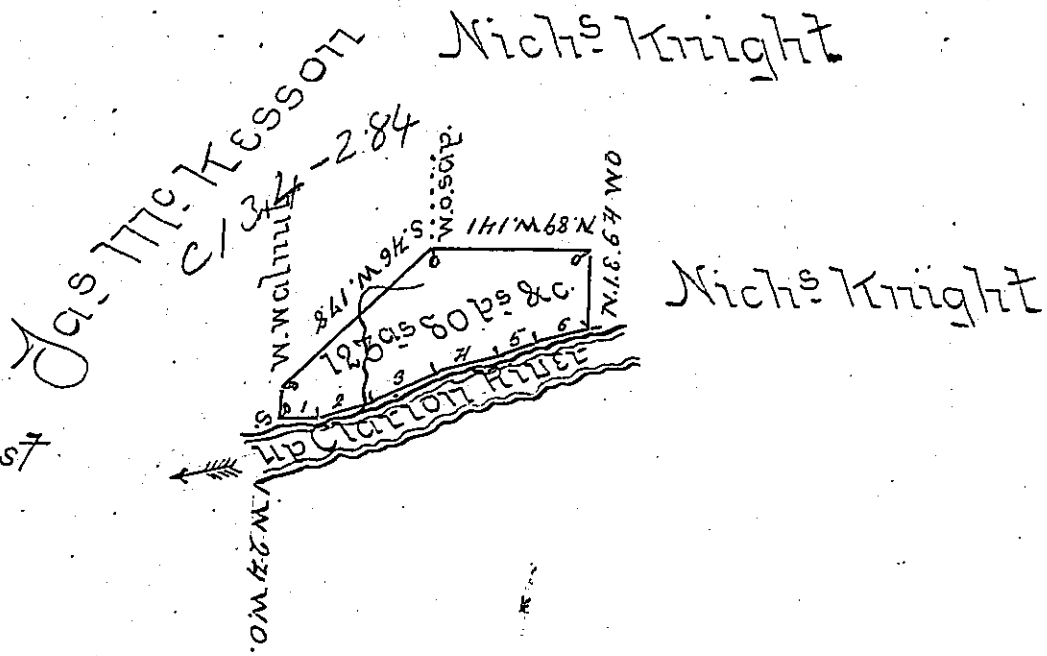

Draft of a tract of land situate in Beaver Township
Venango county, East of the Allegheny River and North
of and adjoining Tobys Creek or Clarion River
Surveyed 8th September 1855 in pursuance of a War-
rant granted to Charles Albert, dated 2nd February
1855

Richd Erwin U.S.

John Naylor Esq. }
Surveyor General of Pa. }

IN TESTIMONY that the above is a copy of the original remaining on file in
the Department of Internal Affairs of Pennsylvania, made
conformably to an Act of Assembly approved the 16th day of
February, 1833, I have hereunto set my Hand and caused
the Seal of said Department to be affixed at Harrisburg,
this fourth day of August 1903.

Francis P. Brown
Secretary of Internal Affairs.